

## HANSA trim kit

suitable for concealed valves with ceramic or spindle head part

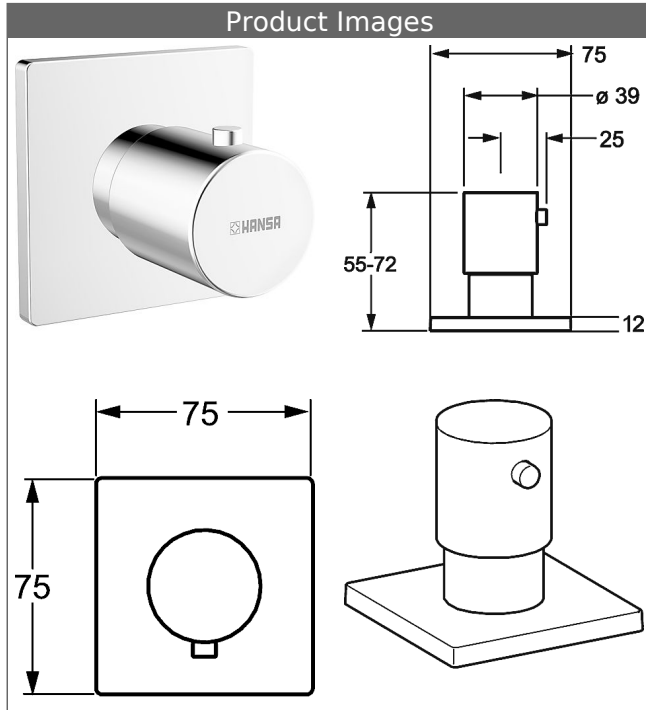

## Description

HANSA  
trim kit  
suitable for concealed valves with ceramic or spindle  
head part

- for volume control valves
- for multi-way diverter 0295 0100
- consisting of:
- chrome handle
- (-) without H+C symbol
- rosette, twist-resistant

Model	Item No.	
chrome	02289172	

For the complete unit please order separately trim kit  
and concealed base unit

Product Image



Product Drawing

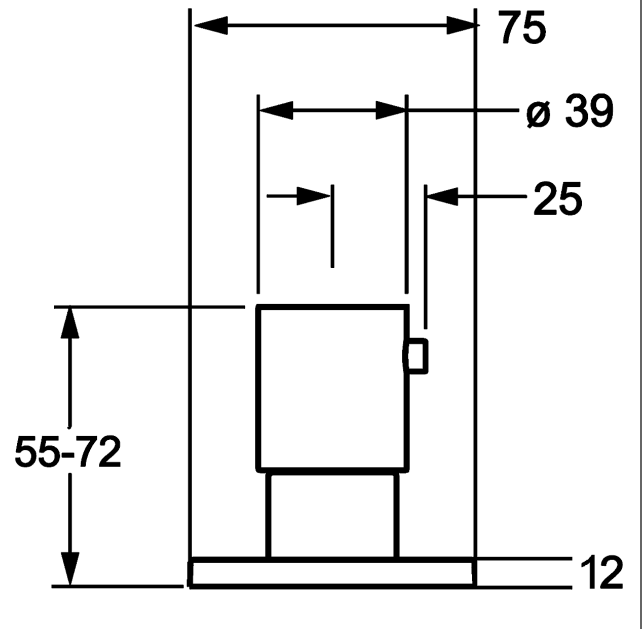

Product Drawing

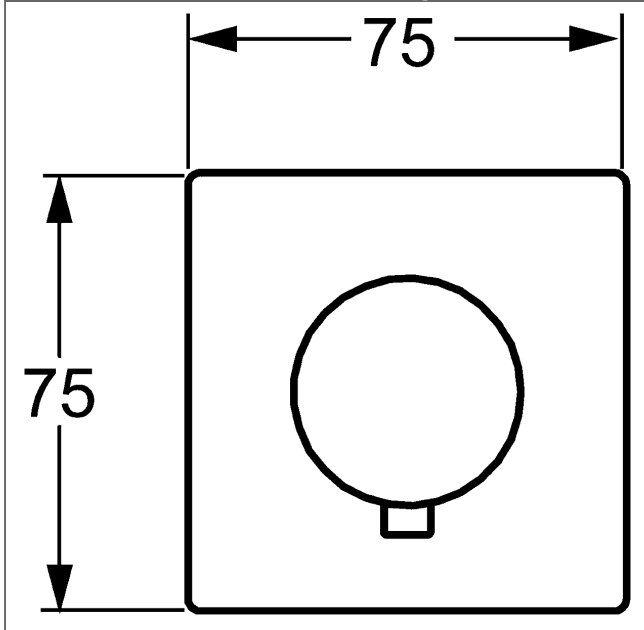

Product Drawing

